



Back to School Information

Everyone is looking forward to welcoming children back to school and resuming the learning and relationships that we all enjoy so much. On the first days back at school, we will be focusing on providing a welcoming and supportive transition with the new teacher. We anticipate children will be excited about the return to school but staff will take time to ensure children settle well, as we commence an important year for learning.

Key dates

On Thursday 2nd September **ONLY**

Thursday 2nd September ONLY Staggered drop off	Year 1, 3 & 5	8.30- 8.40 am	Collection for all 3.30 pm
	Year 2, 4 & 6	9.00 - 9.10 am	

For the first day (2nd September only) if siblings drop off times differ you will need to make two separate drop offs. There is no provision to take children in to class or wait on site for Year 2, 4 & 6.

Friday 3rd September **ONWARDS:**

8.35 - 8.50 am	drop off window
3.30 pm	collection time

- PE lessons begin from Monday 6th September with specific year group PE days to be sent out before the end of the week.
- Thursday 9th & Friday 10th September school is closed for INSET.

What will the school day look like?

The July easing marked a new phase in the government's response to the pandemic, moving away from stringent restrictions on everyone's day-to-day lives, towards advising people on how to protect themselves and others, alongside targeted interventions to reduce risk. Our school approach reflects this change.

- There will be regular hand washing.
- Enhanced cleaning will continue.
- Classroom layout and equipment will return to normal with classes not necessarily seated in row formation.
- We will balance the need for increased ventilation while maintaining a comfortable temperature.
- We will resume small assemblies in the school halls for just one year group (previously two or three) classes will be spaced out in the halls.

Lunches and Snacks

- School meals for children in Year 1 – 6 begin from the first day of term.
- Reception school meals commence Monday 20th September.

Year 1 children (both packed lunch and school dinners) will eat lunch in their classrooms at their desks, which will be wiped by staff beforehand. If any cutlery is required for your child's packed lunch, please send this in with them. Please support the staff by ensuring your child is able to manage opening, eating and tidying away any food they bring in. Please do not send in yoghurts as the classrooms are carpeted.

On the playground

Children will be outside in all weathers for playtime and must have a coat. Year groups will be sharing playgrounds as before Covid.

Resources and equipment your child should have in school:

- a packed lunch
- a water bottle
- a suitable coat (children will be outside in all weathers)
- sun cream (children must be wearing or able to apply this themselves)
- sun hat
- any reading books/learning resources provided by the school
- PE kits on appropriate days.

All resources for learning (pens, pencils etc) are provided by the teacher. We are no longer restricting children from bringing in their own equipment. If you choose to send items in with your child, please do not send in very expensive pencil cases or other items which are easily lost. Children are only allowed to use sponge footballs in the playgrounds, these are also provided.

Parents/carers of those children in Years 5 and 6 who walk themselves to and/or from school may want them to have a mobile phone with them for these walks. This is permitted in school but must remain **switched off and in their school bag** for the duration of the time they are on the school site.

Some younger children occasionally have toileting difficulties. If you know your child may need spare clothes, we would ask that these be included in a plastic bag inside their school bag.

We ask that children are sent in with a healthy snack for break time.

Please do not send in food to be shared with other children in the class this includes sweets for birthdays.

How to communicate with school

We are really pleased to return to more personal communication with face to face conversations on the playground or phone calls.

If you want to speak to your child's teacher:

1. You can speak to the teacher on the playground at the end of the day. Please wait to the side of your class collection point. In the morning, support staff are on the playground should you need to pass on any messages at the start of the day.
2. Call the school office (903 0483) who will pass on a message to your child's teacher to contact you.
3. Complete a [contact form](#) which will be forwarded to your teacher and they will aim to get in touch with you within a couple of school days.

If you want to relay a message about drop off/collection or something similar:

- If it is on the day, please call the office (903 0483)
- If it is the day before or earlier, you can complete [this form](#) which will be received by both the school office and your child's teacher.

If you want to speak to someone about a more general enquiry please contact the school office:

- Please call 903 0483
- You can visit the school office on Bishop Road
- Complete the [contact form](#) selecting office in the drop down bar.

We will continue to use Class Dojo as a platform to support learning if children are off school with Covid related absences. Similarly to last year, we will not be using the messenger feature.

The above methods replace the previous contact arrangements. The [info and year group emails](#) are no longer in use.

Uniform

Pupils will be expected to wear correct school uniform every day, including footwear.

Please remember that there is a [new requirement for uniform](#) for PE lessons from September.

Please ensure that all school uniform is clearly labelled.

We understand there may remain delays in the supply chain for some sizes of the bespoke jumper and cardigan. If you have been unable to purchase the uniform, please send your child in wearing a plain dark coloured jumper (navy blue or black) until you receive your order. Please do not send them to school in a hoodie. All other items of the uniform and PE kit are readily available from a variety of shops.

Lost property

A lost property box will be reinstated in the Boat Playground under the sheltered area. We will endeavour to reunite children with their belongings and require all items that come into school to be labelled.

First Aid and Medication

Mrs Cooper will coordinate the arrangements for First Aid and medical needs in school. Any medication currently held in school for children will be stored out of reach in the child's classroom and not the office. The relevant teacher will be aware of the Health Plans for each child in their class. For any questions, changes or new medication please call the school office and Mrs Cooper will be happy to discuss any necessary arrangements.

What happens if my child has symptoms of coronavirus?

Pupils, staff and other adults should follow public health advice on [when to self-isolate and what to do](#). They should not come into school if they have symptoms, have had a positive test result or other reasons requiring them to stay at home due to the risk of them passing on COVID-19 (for example, they are required to quarantine).

If anyone in school develops [COVID-19 symptoms](#), however mild, we will send them home and they should follow public health advice.

The most important symptoms of coronavirus (COVID-19) are recent onset of any of the following:

- a new, continuous cough
- a high temperature (37.8 degrees Celsius or above)
- a loss of, or change in, your normal sense of taste or smell (anosmia).

For everyone with symptoms, they should avoid using public transport and, wherever possible, be collected by a member of their family or household.

If a child begins to display symptoms of coronavirus during the school day, they will be moved to a safe space where they can be isolated and safely observed by an adult until they can be collected.

What if someone other than my child tests positive?

- From 16 August 2021, children under the age of 18 years old are no longer required to self-isolate if they are contacted by NHS Test and Trace as a close contact of a positive COVID-19 case.
- Instead, children will be contacted by NHS Test and Trace, informed they have been in close contact with a positive case and advised to take a PCR test.

Face coverings

Face coverings are no longer advised for pupils, staff and visitors either in classrooms or in communal areas.

The government has removed the requirement to wear face coverings in law but expects and recommends that they are worn in enclosed and crowded spaces where people may come into contact with others who they don't normally meet.

We understand that people will make different decisions about the current guidance.

We expect everyone on site to be courteous and polite, respecting each other's decisions regarding wearing or not wearing face coverings.

Remote education

There will continue to be work available on Class Dojo for children to access if they are off school due to Covid. This will take the form of accessible tasks, activities and set work which will be marked by the class teacher.

Drop off and collection

This is the busiest part of the day and we would ask that you read this carefully to ensure the safe arrival and departure of large numbers of people within a short timeframe.

- Please use the correct gate to enter and exit through when dropping off and collecting.
- Once you have entered the school site through the correct gate, walk directly to the relevant drop off/collection point; there are no longer line markings and there is no requirement to move or queue in a line.
- You can leave messages with support staff who are on the doors in the mornings and are free to wait to speak to the teacher on the playground at the end of the day.
- Where possible, please avoid bringing scooters or bikes (including adults) onto the school site. If you intend to stop and speak to a teacher, please do not bring your bike into the playground.
- Do not allow your children to ride or scoot on the playground and please do not bring dogs on site.
- Where parents/carers feel it is safe to do so, we would encourage children in Year 5 and 6 to walk independently to and from school. It may be that you choose to allow your child to do so after the first week when they are familiar with the system. On the first day, we ask that all children be accompanied by an adult to support them in understanding the arrangements.
- Families are able to move from the Grant playground to the Silverthorne playground. However, this remains a one way system and we ask that all families dropping off and collecting children in the Silverthorne playground exit onto Monk Road to maintain a one way system.

We have prepared videos to support your understanding of these new systems– which can be found in the ‘Back to School Information’ section on the homepage.

Friday 3rd September onwards

8.35 – 8.50 am	drop off window
3.30 pm	collection time

Year 1–6 drop off and collection information

The arrangements are essentially the same as last academic year but without the requirement to follow line markings and queue.

Drop off (Year 1–4)

- Please enter via Bishop Road and head to the drop off door for your child/ren.
- At the drop off door, your child should leave you and walk into the classroom independently.
- Please continue on and exit via Cambridge or the wooden gate to Monk Road.
- **If you have a child/ren in Year 5 or 6**, continue through the school, into the Silverthorne Playground and drop off at the allocated door. Exit via the wooden gate onto Monk Road.
- The support staff are on hand to help welcome your child into the classroom. If you need to pass a message to the teacher, they will be able to do this for you.

Drop off (Year 5 & 6)

- Please enter via the metal gate on Monk Road and head to the drop off door for your child/ren.
- At the drop off door, your child should leave you and walk into the classroom independently.
- Please loop back and exit via the wooden gate in the Silverthorne playground onto Monk Road.
- The support staff are on hand to help welcome your child into the classroom. If you need to pass a message to the teacher, they will be able to do this for you.

Collection (Year 1 & 2)

- At 3.30pm the gates will be opened. Please enter via Bishop Road and head to the collection point where your child will be waiting for you.
- When you approach the teacher at the collection point, please say your child's name clearly.
- The teacher will give your child a thumbs up sign to indicate they can leave.
- Unless you are waiting to speak with a teacher, please continue through the site after collecting your children, leaving via the Cambridge Road or wooden gate onto Monk Road
- **If you have a child/ren in Year 5 or 6**, continue through the school and into the Silverthorne playground and collect your child, leaving via the wooden gate onto Monk Road.

Collection (Year 3 – 6) only

- At 3.30pm the gates will be opened. Please enter via the metal gate on Monk Road and head to the collection point where your child will be waiting for you.
- When you approach the teacher at the collection point, please say your child's name clearly.
- The teacher will give your child a thumbs up sign to indicate they can leave.
- Unless you are waiting to speak with a teacher, please leave through the Silverthorne playground via the wooden gate onto Monk Road.

Families are able to move from the Grant playground to the Silverthorne playground. However, this remains a one way system and we ask that all families dropping off and collecting children in the Silverthorne playground exit onto Monk Road to maintain a one way system.

Late drop off to the school is immensely disruptive to the smooth running of the entire school day and we have limited capacity to facilitate entry into the school for those children who are late. If you are late, please wait with your child by the main gate to the left of the school office on Bishop Road. Children in Year 5 and 6 walking independently who arrive late should also come to this point.

Reception drop off and collection information

Classes RK and RU

(after the initial induction weeks)

Please use the one-way system in the Reception playground at the front of the school, entering and exiting through the gates on Bishop Road.

Drop off

- As you reach your child's classroom door your child should leave you and walk into the classroom independently.
- The class teacher or support assistant will be at the door waiting to help welcome your child into the classroom or take any messages for you.
- Please continue through the playground to the exit gate by the climbing frame.

Collection

- Classes will be outside in the playground before the gates are opened.
- When you approach the teacher please say your child's name clearly.
- The teacher will give your child a thumbs up sign to indicate they can leave.
- Unless you are waiting to speak with the teacher, please continue through the site after collecting your children, leaving via Cambridge or Monk Road exit gates.

Classes RH and RM

(after the initial induction weeks)

For drop-off, please enter the one-way system through the gate to the right hand side of School House on Bishop Road. Exit onto Cambridge Road at the end of the route. Please be aware of the route merging with another one-way system as you exit. For collection, please follow the main one-way system through the black gates on Bishop Road and into the Boat Playground.

Drop off

- When you arrive at your child's drop-off point, your child should leave you and walk into the building independently.
- The class teacher or support assistant will be at the door waiting to help welcome your child into the classroom or take any messages for you.
- Please continue along the path and leave the site without stopping.

Collection

- At 3.30pm the gates will be opened. Please enter via Bishop Road or Monk Road wooden gate and head to the collection point where your child will be waiting for you.
- When you approach the teacher at the collection point please say your child's name clearly.
- The teacher will give your child a thumbs up sign to indicate they can leave.
- Unless you are waiting to speak with a teacher, please continue through the site after collecting your children, leaving via Cambridge or Monk Road exit gates.

Drop off Map

Please watch the videos on the website which show the entry routes for each class.

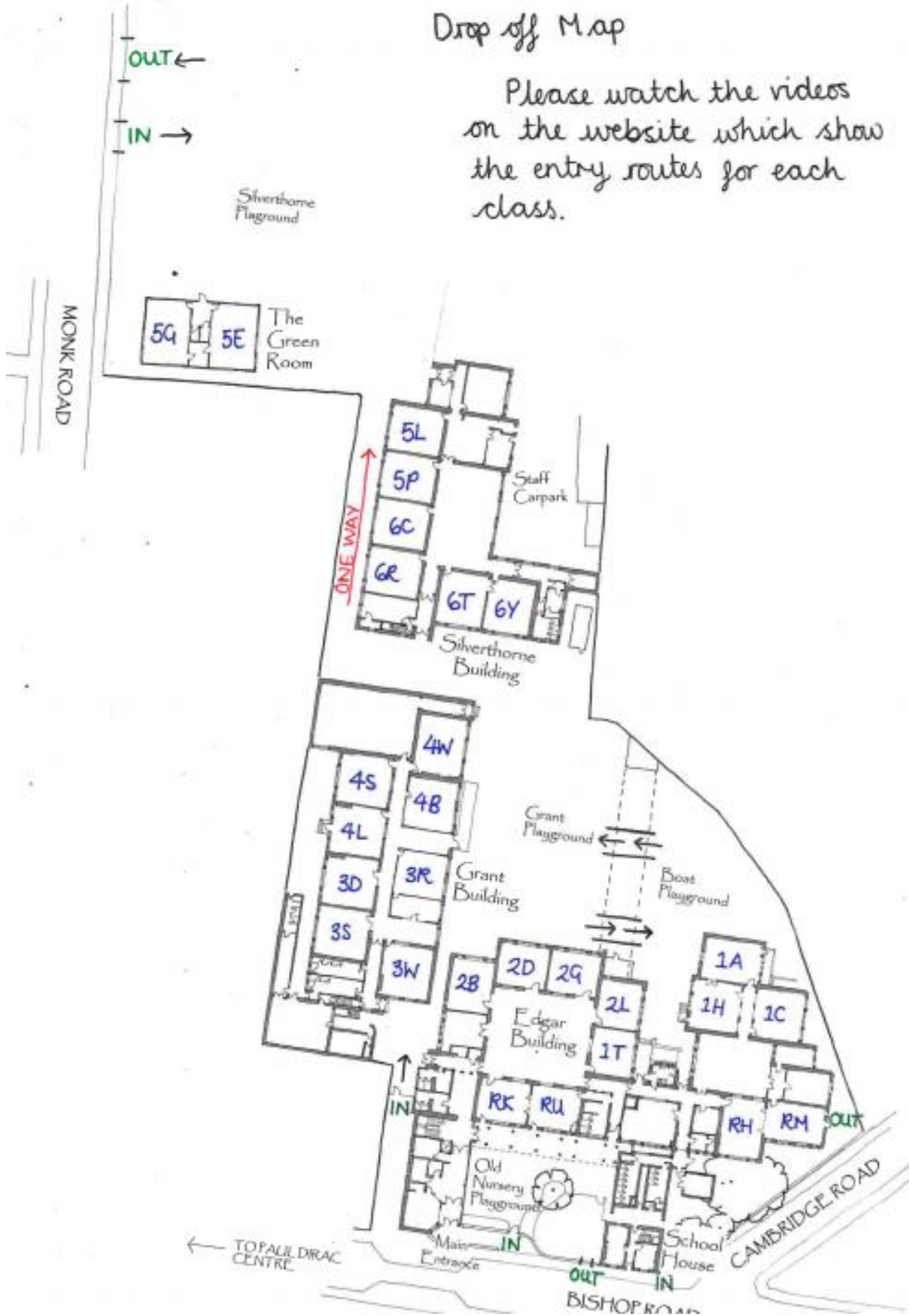

Collection Map

